

Building Instructions



Touch and Light Sensor Attachment

Touch and Light Sensor Attachment

- 8x TECHNIC Pin with Friction
- 2x TECHNIC Pin Long with Friction
- 2x TECHNIC Axle Pin with Friction
- 2x TECHNIC Axle Pin
- 2x TECHNIC Axle 6
- 2x TECHNIC Axle 3
- 2x TECHNIC Axle 5
- 4x TECHNIC Bushing
- 1x TECHNIC Brick 1 by 6
- 2x TECHNIC Connector Crank
- 2x TECHNIC Crossblock Black
- 2x TECHNIC Angle Beam
- 2x TECHNIC Beam 7

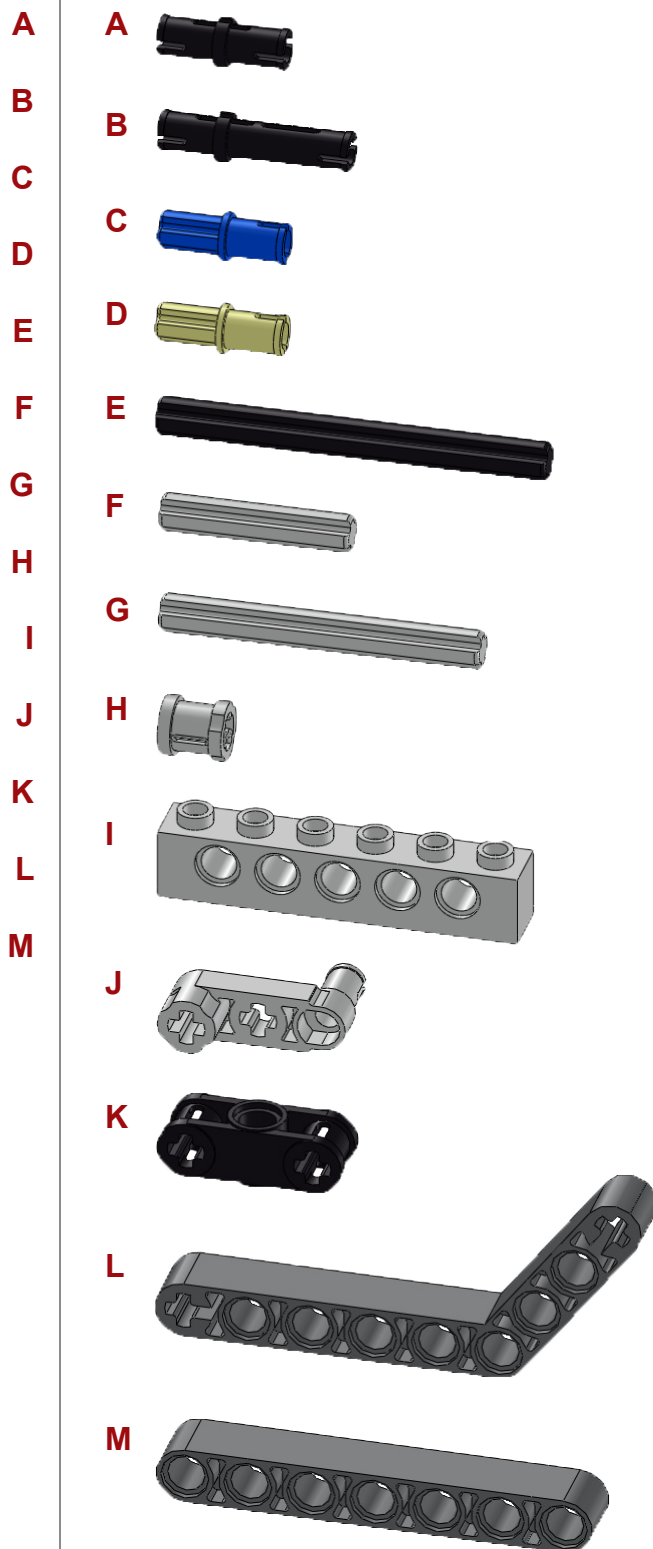

Touch and Light Sensor Attachment

- 4x TECHNIC Beam 3
- 2x TECHNIC Angle Beam 9 by 5
- 1x LEGO NXT Light Sensor
- 1x LEGO NXT Touch Sensor
- 2x LEGO NXT Wire

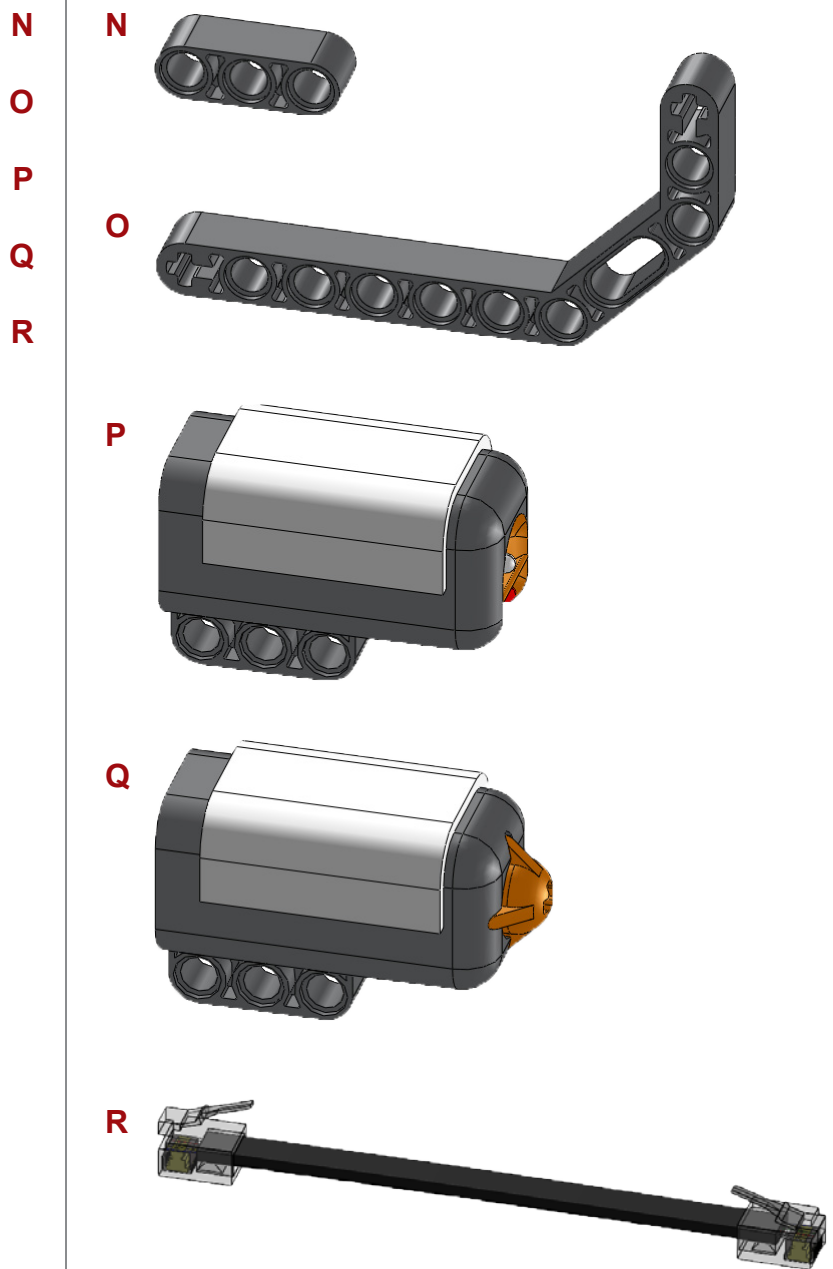

1

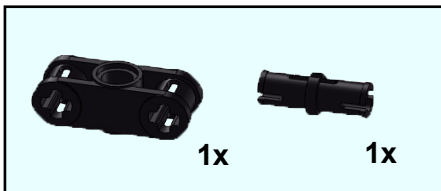

2

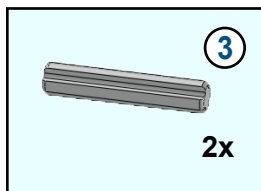

3

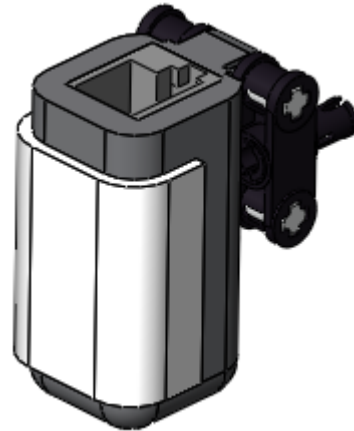
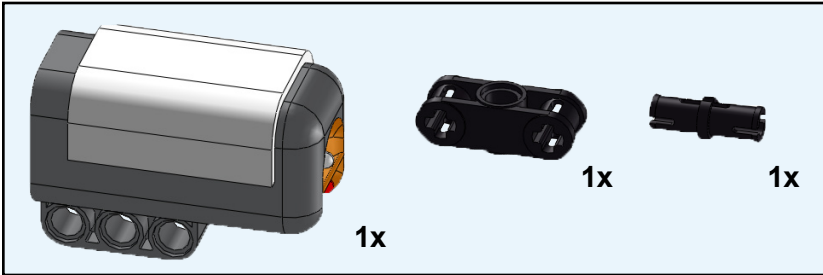

4

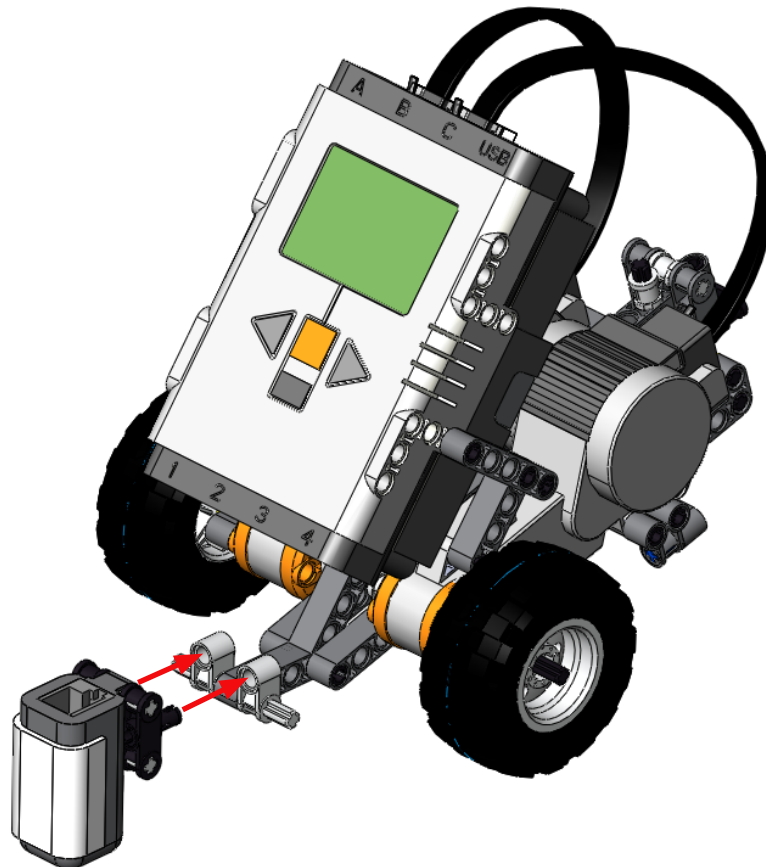

5

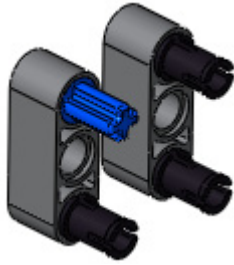
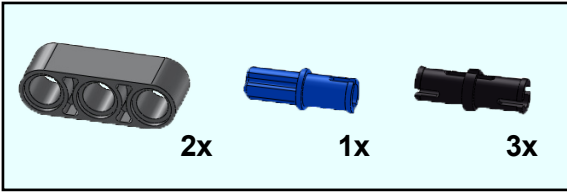

6

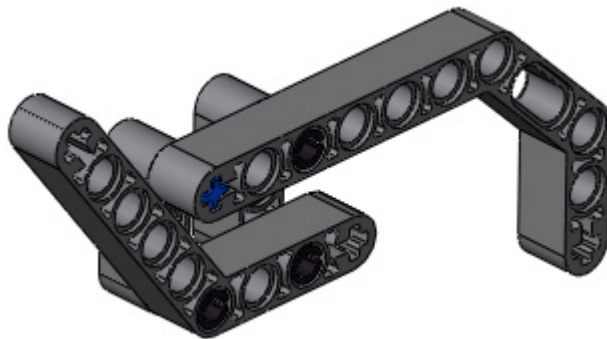
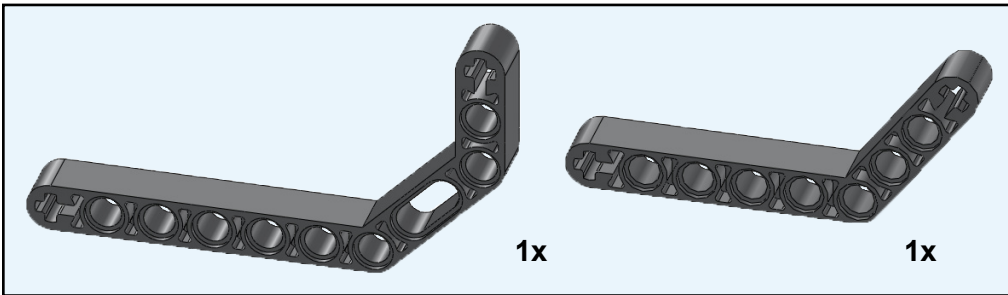

7

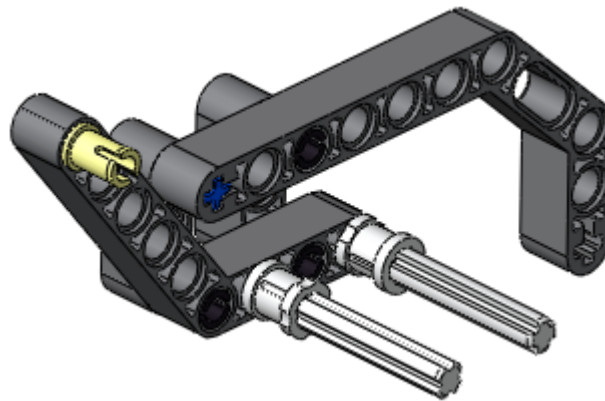
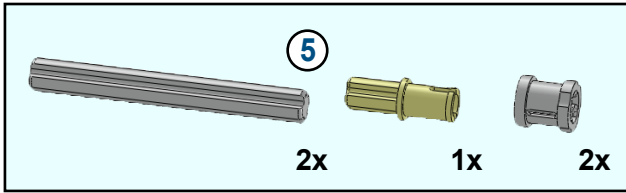

8

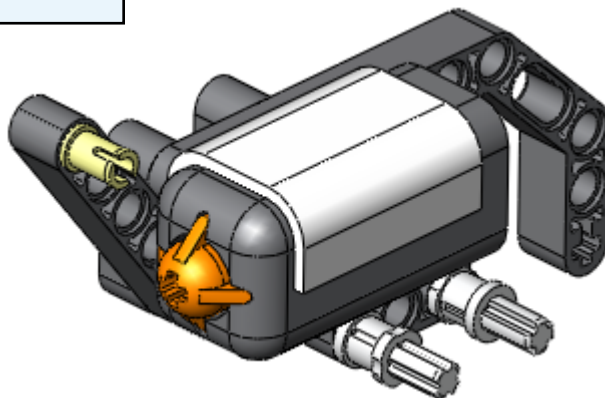
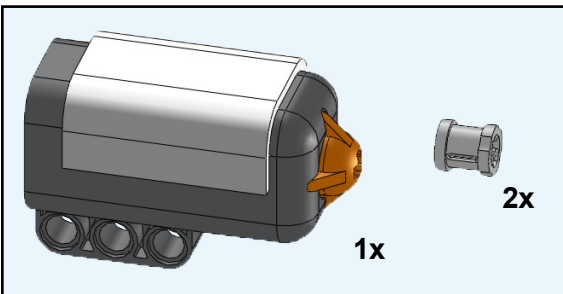

9

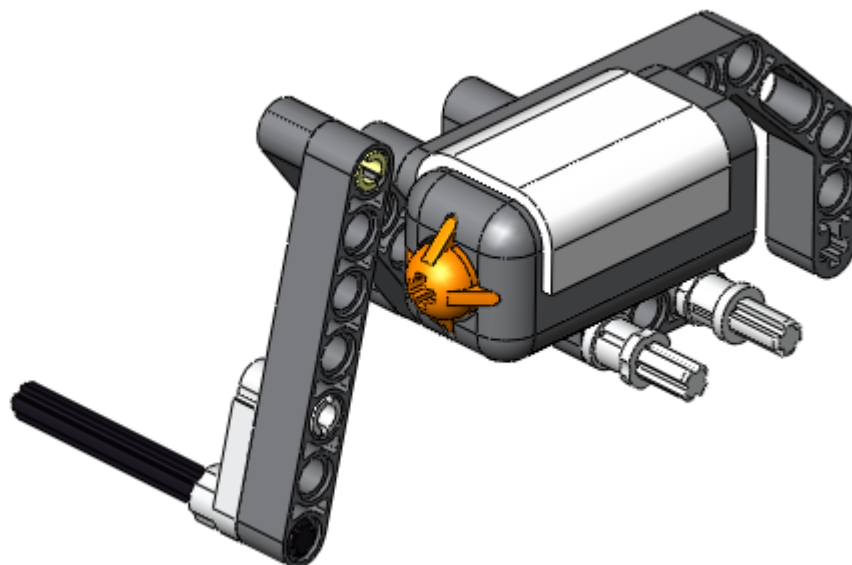
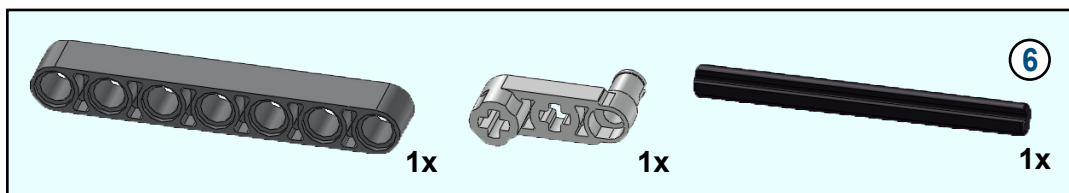

10

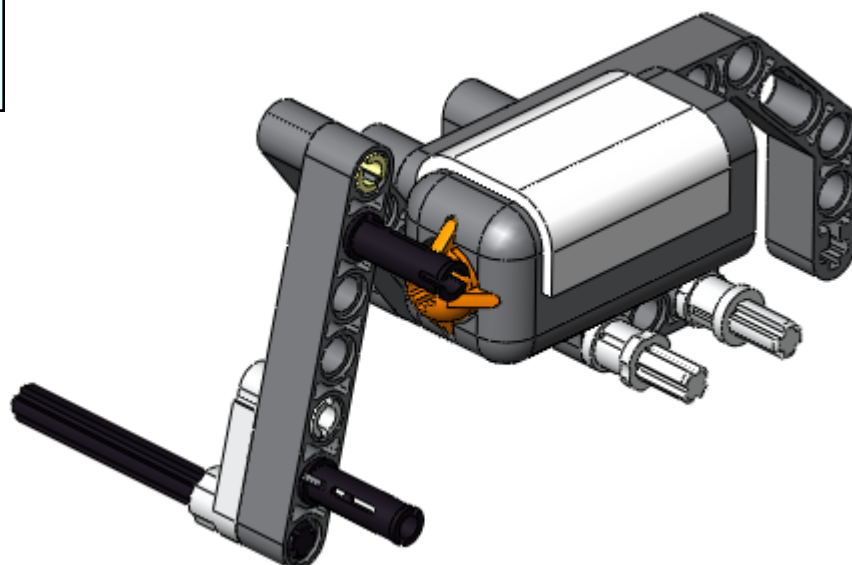

11

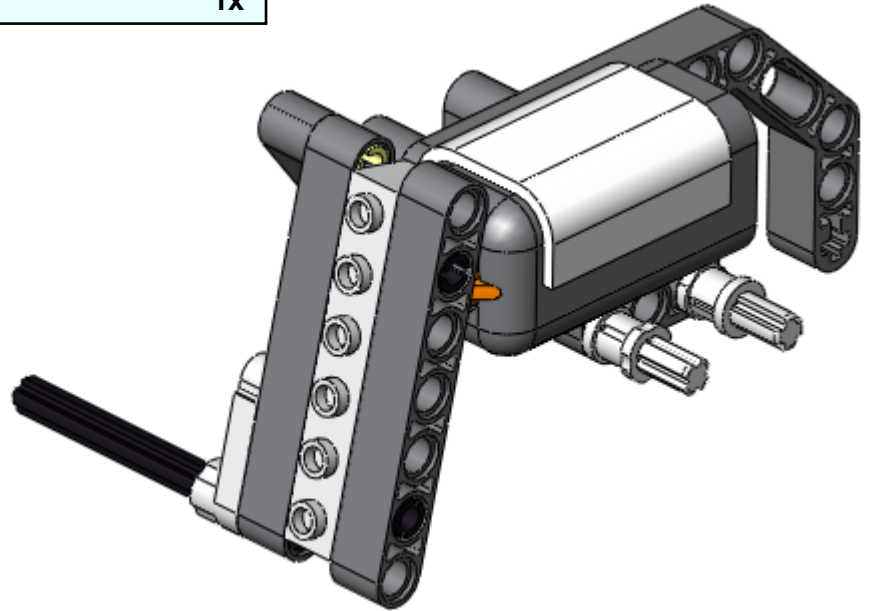
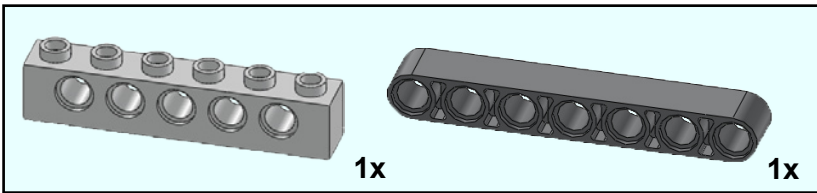

12

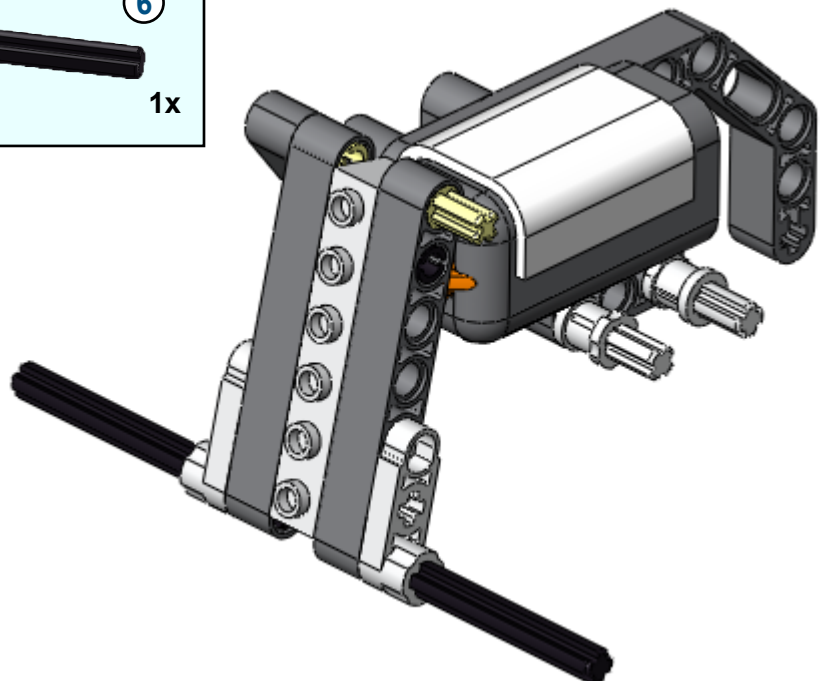
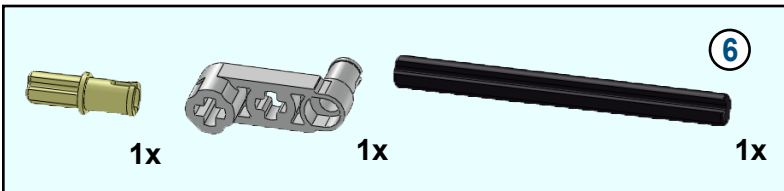

13

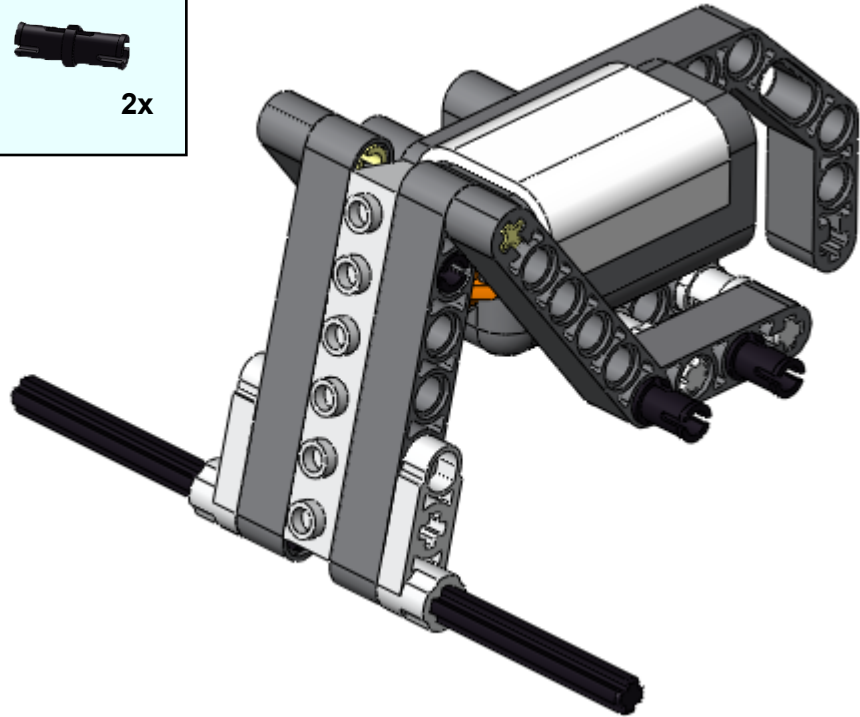
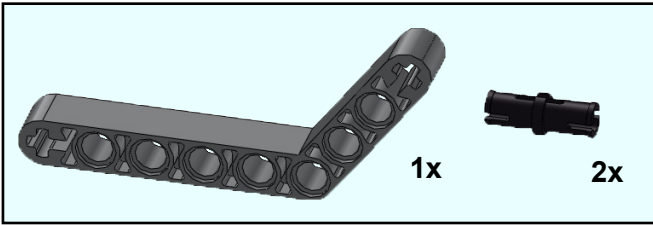

14

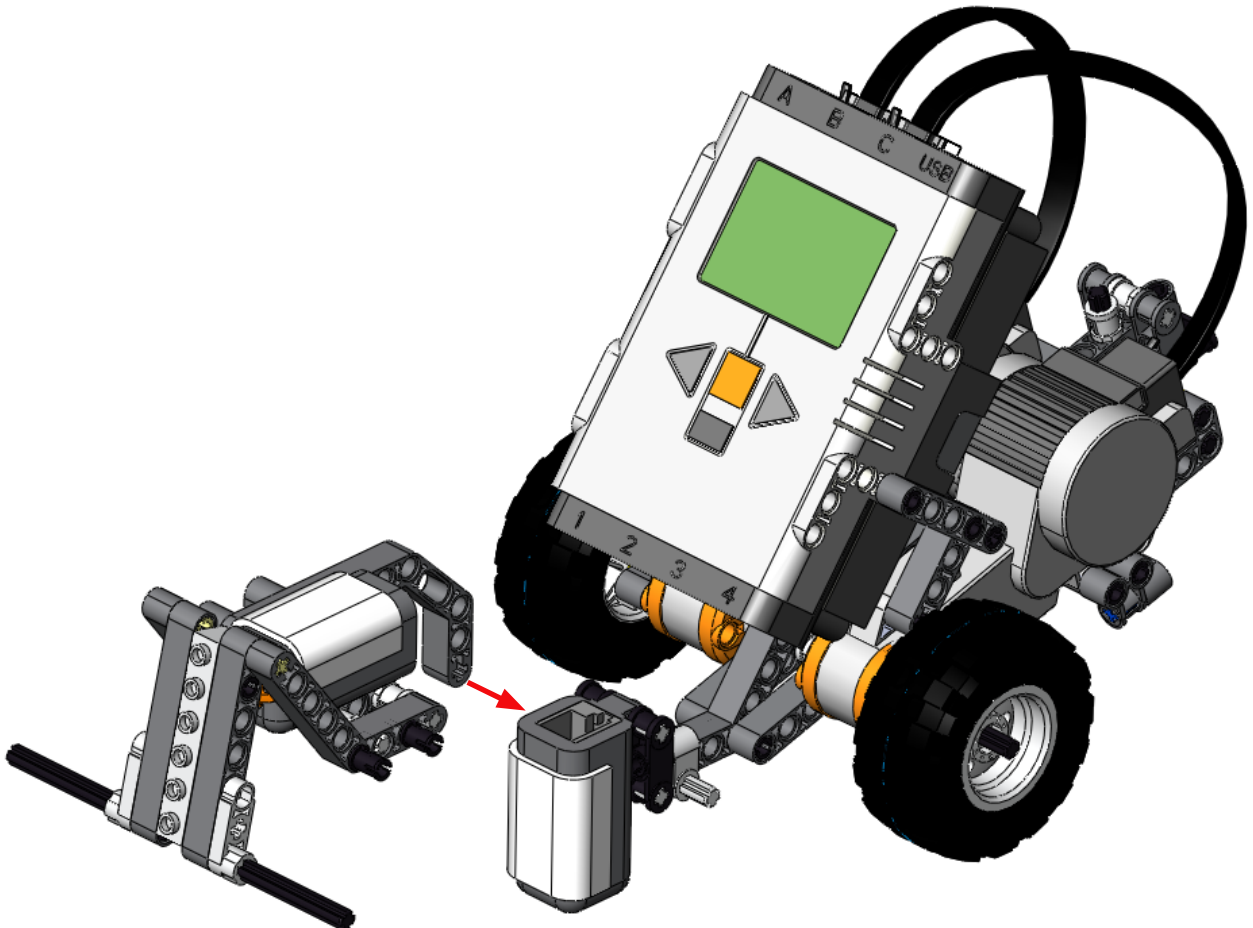

15

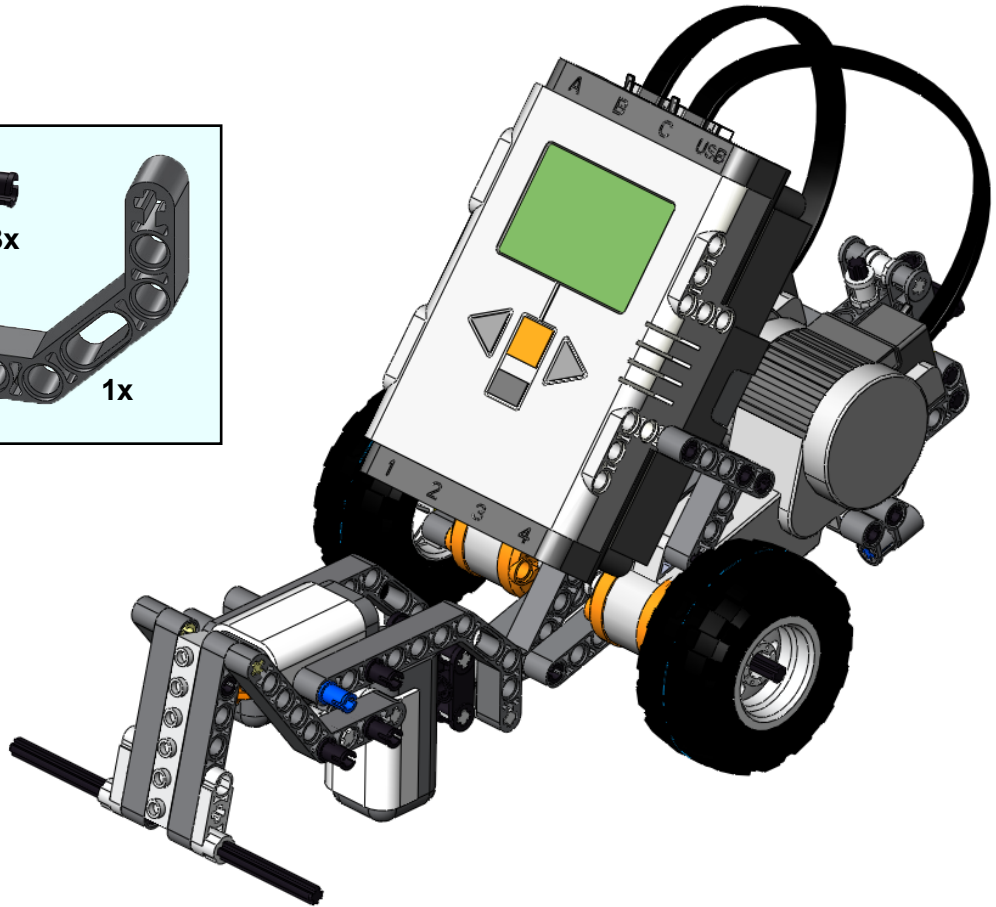
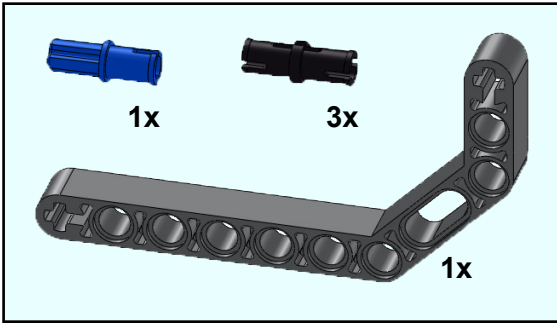

16

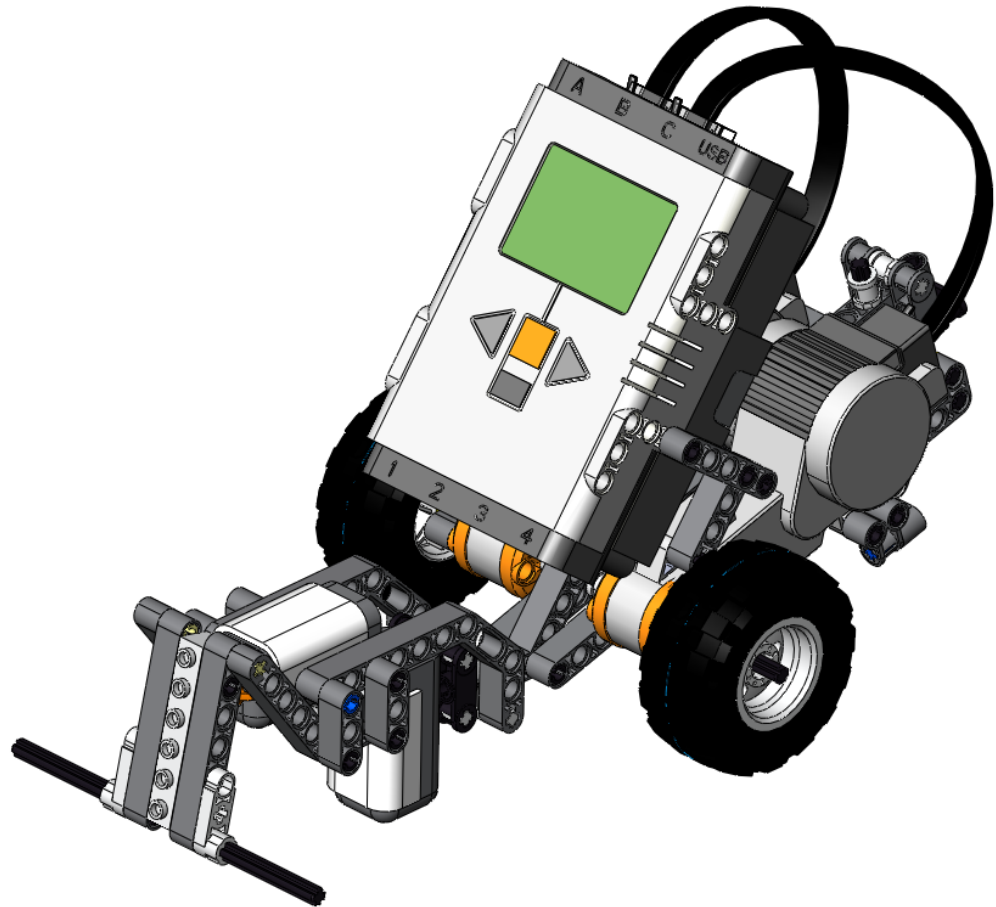
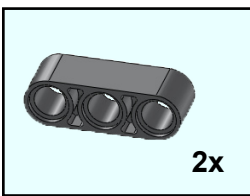

17

